

AREA 1 - BRIDGE OF REMEMBRANCE

- Memorial space defining western gateway into precinct
- Improved connection to Cambridge Terrace and future Ngai Tahu Cultural Centre

AREA 2 - WEST CASHEL ST

- Garden rooms to facilitate outdoor dining, art installations and gathering in sunny portion of street
- Open sightlines to Bridge of Remembrance
- Movement corridor for emergency vehicles, deliveries and managed public access
- Arching feature lights capable of providing power for a future tram

AREA 3 - CENTRAL CASHEL ST

- An urban pedestrian space to accommodate retail customers and students

- This portion of the street subtly references local braided rivers through layout and detailing
- Local metaphors reinforced through colourful lighting and a fountain in the Events Bosque Plaza

AREA 4 - EAST CASHEL ST

- Located within the intensively developed hotel precinct
- Provides two planted Bosque groves to protect the street environment from swirling wind
- Bosque plazas can be activated by small kiosks (such as converted tram cars) for cafe or florist uses
- Events can be accommodated in a variety of layouts

AREA 5 - STEWART PLAZA / HIGH STREET NORTH

- Stewart Plaza (location of the current Stewart Fountain) will provide a conspicuous linkage between Cathedral Square and City Mall via tall sculptural markers such as lighting and a Neo

Gothic Tutour, or vine climber.

- Ample seating for pause or cafe dining will take advantage of great solar exposure

AREA 6 - PORT HILLS PLAZA / HIGH STREET SOUTH

- Located at the Lichfield / Manchester corner, Port Hills Plaza will utilise a new 8m high sculpture to frame this important and historical processional route to the Port Hills.
- A raised landscape space will provide a viewing prospect to the Port Hills

AREA 7 - COLOMBO STREET

- Reinforcing Christchurch's mainstreet, strengthened through use of feature lighting, neon artwork
- Strengthen views into and out of Cathedral Square through use of planting and street elements.

City
Mall

Concept Design

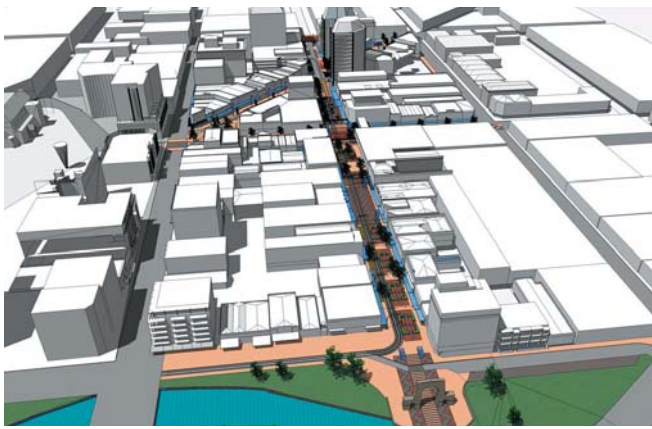
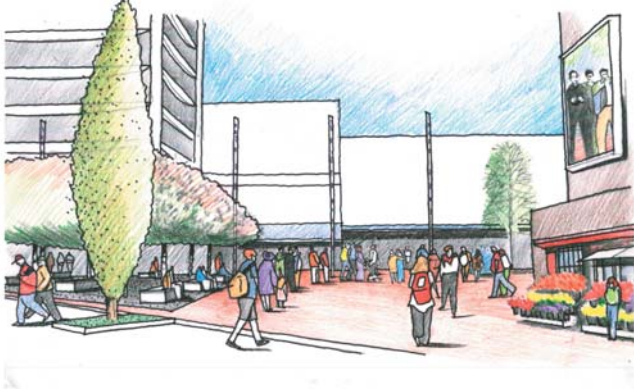
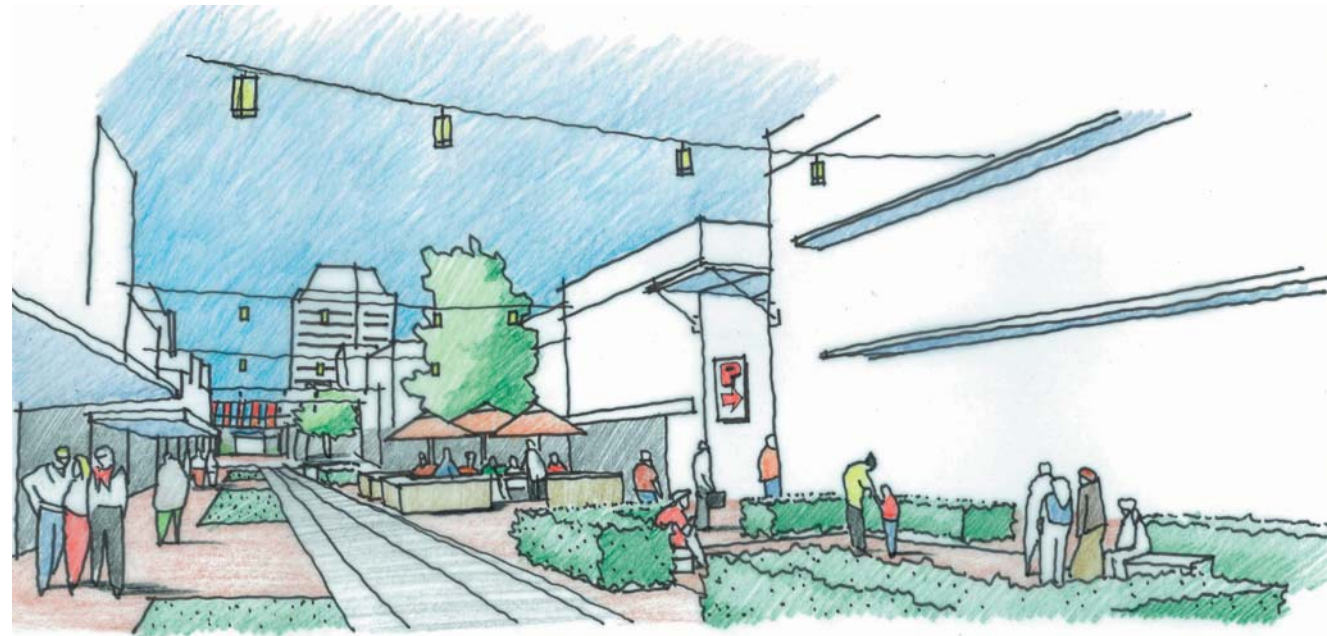

City
Mall

Concept Design

August 2006