



**Christchurch City Council**

**SHIRLEY/PAPANUI COMMUNITY BOARD  
GREENSPACE TRAFFIC WORKS COMMITTEE  
AGENDA**

**MONDAY 16 JUNE 2008**

**AT 4.00 PM**

**IN THE BOARDROOM  
PAPANUI SERVICE CENTRE  
CORNER LANGDONS ROAD AND RESTELL STREET**

**Committee:** Matt Morris (Chairperson), Ngaire Button, Pauline Cotter, Megan Evans, Aaron Keown, Yvonne Palmer and Norm Withers.

**Community Board Adviser**  
Peter Croucher  
Phone 941 5414  
Email: [peter.croucher@ccc.govt.nz](mailto:peter.croucher@ccc.govt.nz)

- PART A - MATTERS REQUIRING A COUNCIL DECISION**
- PART B - REPORTS FOR INFORMATION**
- PART C - DELEGATED DECISIONS**

<b>INDEX</b>	<b>PG NO</b>	
<b>PART C</b>	<b>2</b>	<b>1. APOLOGIES</b>
<b>PART C</b>	<b>2</b>	<b>2. CONFIRMATION OF MEETING REPORT – 19 MAY 2008</b>
<b>PART B</b>	<b>8</b>	<b>3. DEPUTATIONS BY APPOINTMENT</b>
<b>PART B</b>	<b>8</b>	<b>4. UPDATE FROM THE CONTRACTS AND MAINTENANCE TEAM</b>
<b>PART B</b>	<b>9</b>	<b>5. BEALEY AVENUE - P5 AT ANY TIME PARKING RESTRICTION</b>
<b>PART B</b>	<b>12</b>	<b>6. THE YOUNG TOTARA AWARD</b>
<b>PART B</b>	<b>20</b>	<b>7. COMMITTEE MEMBERS' INFORMATION EXCHANGE</b>

**1. APOLOGIES**

Megan Evans and Aaron Keown

**2. CONFIRMATION OF MEETING REPORT – 19 MAY 2008**

The report of the Greenspace Traffic Works Committee meeting of 19 May 2008 is **attached**.

**STAFF RECOMMENDATION**

That the report of the Greenspace Traffic Works Committee meeting of 19 May 2008, be confirmed.

**CHAIRPERSON'S RECOMMENDATION**

That the staff recommendation be adopted.

16. 6. 2008

- 3 -

ATTACHMENT TO CLAUSE 2

16. 6. 2008

**SHIRLEY/PAPANUI COMMUNITY BOARD'S  
GREENSPACE TRAFFIC WORKS COMMITTEE  
19 MAY 2008**

**A meeting of the Greenspace Traffic Works Committee  
was held on Monday 19 May at 4.00 pm  
in the Boardroom, Papanui Service Centre**

**PRESENT:** Matt Morris (Chairperson), Pauline Cotter, Aaron Keown and Yvonne Palmer.

**APOLOGIES:** Apologies for absence were received and accepted from Ngaire Button, Megan Evans and Norm Withers.

The Committee reports that:

**PART B - REPORTS FOR INFORMATION**

**1. DEPUTATIONS BY APPOINTMENT**

**1.1 KATE HEWSON – TRANSITION COMMUNITIES**

Dr. Kate Hewson and Roger Buck of Sustainable Otautahi Christchurch Incorporated (SOC) spoke on their aim, which was "Recognising Te Tiriti O Waitangi/The Treaty of Waitangi, to actively contribute within Otautahi/Christchurch to opportunities and means for achievement of long-term sustainability. In doing so, to seek to ensure that all people have their basic needs satisfied, so that they can live in dignity, in healthy communities, while having the minimum adverse impact" . Transition Communities is a sub group of SOC based on United Kingdom transition town models and seek to move urban environments to a sustainable footing in the face of climate change and Peak Oil.

It was **agreed** that the Greenspace Traffic Works Committee, on behalf of the Board, endorses the concept of Christchurch transition communities, and agrees to support, as appropriate, transition community initiatives arising in the Shirley/Papanui area.

Transition examples were requested to ensure a cohesive approach (i.e. school gardens, community gardens, farmers' gardens and behaviour). Merit was seen in the presentation also being made to a Zone 5 meeting of Local Government New Zealand.

**1.2 DANNY LEE AND MR HA – STYX MILL BUS ROUTE EXTENSION THROUGH NORTHWOOD – BUS STOPS**

Mr Lee and Mr Ha outlined concerns regarding the proposal to place bus stops between 149 and 151 Hussey Road and these included fears for their personal safety, views to their properties by the public and the dangers of a narrow road with many property entranceways. Their preference was to relocate the bus stop towards the gas installation.

It was **agreed** that staff be asked to comment when the report on the topic was presented later in the meeting. Clause 7 (Part C) of this report refers.

**2. BRIEFINGS**

Nil.

**3. UPDATE FROM CONTRACTS AND MAINTENANCE TEAM**

Nil.

**4. COMMITTEE MEMBERS' INFORMATION EXCHANGE**

- **Edgware Road/Colombo Street - Safety Concerns**

It was **agreed** that staff would follow up a previous request from the Board for a public meeting with the nearby residents and business owners to discuss road safety improvements.

- **Northfield Road -Traffic Concerns**

It was **agreed** that a public meeting should proceed to address Mr Peter Tucker's concerns.

- **River Road - Bank and Trees**

An email from Al Crawford was tabled requesting remedial work on a stretch of the river bank in River Road. Members noted this was in the Hagley/Ferrymead Ward and needed to be referred to that Board.

- **Tree Trimming**

It was suggested that members take a proactive role in reporting cases where tree/plant trimming was required for reasons of pedestrian safety and access.

**PART C – REPORTS ON DELEGATED DECISIONS TAKEN BY THE COMMITTEE**

**5. CONFIRMATION OF REPORT – 14 APRIL 2008**

The Committee **resolved** that the report of the Greenspace Traffic Works Committee meeting of 14 April 2008, be confirmed.

**6. SPENCER BEACH HOLIDAY PARK – PROPOSED INCREASE IN CAMP CHARGES**

The Committee's approval was sought to increase user charges at the Spencer Beach Holiday Park in line with the provisions of the lease.

The Committee **resolved** to approve the submitted schedule of increased charges for the Spencer Beach Holiday Park to apply from 1 June 2008.

**7. PROPOSED ROAD NAMINGS**

The Committee was asked to approve three new road names on two subdivisions, with one of these being a reconsideration of 'Marble Court'.

The Committee **resolved** to approve the proposed names 'Northwater Drive', 'Rosebank Close', and 'Marble Court'.

**8. STYX MILL BUS ROUTE EXTENSION THROUGH NORTHWOOD – BUS STOPS**

The Committee considered a report from staff requesting approval for the installation of the final three bus stops necessary for the extension of the No. 11 Styx Mill bus route through Northwood. The Committee also took into consideration the submissions made by the joint deputation earlier in the meeting (clause 1.2 refers).

Staff explained the safety and operational aspects of bus stop siting including locality, lighting, crime prevention principles and ensuring that bus stops were positioned within a 400 metre catchment area.

In terms of placing a bus stop by the Northwood gas tank, advice from the Hazardous Waste Officer was tabled which noted the danger of the proximity of bus passengers to the installation when a LPG tanker was on site. Speed threshold improvements for cars entering the built up area from Hussey Road are to be explored.

The Committee **resolved**:

To approve the following bus stops:

(a) **Saracen Avenue - Outbound**

A bus stop on the eastern side of Saracen Avenue commencing at a point 67 metres north from its intersection with Handel Place and extending in a northerly direction for a distance of 18 metres (17/19/21 Saracen Avenue).

(b) **Saracen Avenue - Inbound**

A bus stop on the western side of Saracen Avenue commencing at a point 6 metres north from its intersection with Handel Place and extending in a northerly direction for a distance of 18 metres (next to Christchurch City Council reserve land near 20 Saracen Avenue) Hussey Road.

(c) To revoke the bus stop, as resolved at the 18 February 2008 meeting of the then Traffic Works Committee, on the north side of Beechwood Drive at the property boundary of numbers 50 and 52 Beechwood Drive (this stop was not installed).

(d) **Hussey Road**

A bus stop on the north side of Hussey Road commencing anywhere from a point 59 metres east of the eastern edge of its intersection with Watermill Boulevard (the eastern side of the driveway entrance to 147 Hussey Road) to a point 103 metres east of the eastern edge of its intersection with Watermill Boulevard (just short of the eastern most boundary of 151 Hussey Road) and extending in a westerly direction for a distance of 18 metres (in front of one or two of 147, 149 or 151 Hussey Road – the exact location to be decided by the residents or the Community Board).

**9. NORTHWOOD BUS ROUTE – PROPOSED “NO STOPPING” RESTRICTIONS AT THE INTERSECTION OF BEECHWOOD DRIVE AND SARACEN AVENUE**

The Committee’s approval was sought to install no stopping restrictions at the intersection of Beechwood Drive/Saracen Avenue.

The Committee **resolved**:

To approve the stopping of vehicles being prohibited at any time:

(a) On the north side of Beechwood Drive commencing at a point 15 metres west of the western edge of the intersection of Beechwood Drive with Saracen Avenue and extending to a point 18 metres east of the eastern edge of the intersection of Beechwood Drive with Saracen Avenue. (Note that in this case the point of intersection of the two streets has been defined by a line extended from the kerb line in Saracen Avenue).

**9. Cont'd**

- (b) On the south side of Beechwood Drive commencing at a point 10 metres from the western edge of the intersection of Beechwood Drive with Saracen Avenue and extending around on the west side of Saracen Avenue to a point 28 metres from the point of intersection.
- (c) On the south side of Beechwood Drive commencing at a point 30.5 metres from the eastern edge of the intersection of Beechwood Drive with Saracen Avenue and extending around on the east side of Saracen Avenue to a point 21 metres from the point of intersection.

**10. HERCULES/SABINA STREET – PROPOSED “NO STOPPING” RESTRICTION**

The Committee was asked to approve the installation of four sections of broken yellow no stopping lines on the corner of Hercules Street and Sabina Street.

The Committee **resolved:**

To approve the stopping of vehicles being prohibited at any time:

**Hercules Street**

- (a) On the south side of Hercules Street commencing at its intersection with Sabina Street and extending in an easterly direction for a distance of 15 metres.
- (b) On the south side of Hercules Street commencing at its intersection with Sabina Street and extending in a westerly direction for a distance of 15 metres.
- (c) On the north side of Hercules Street commencing at its intersection with Sabina Street and extending in a westerly direction for a distance of 15 metres.
- (d) On the north side of Hercules Street commencing at its intersection with Sabina Street and extending in an easterly direction for a distance of 15 metres.

**Sabina Street**

- (a) On the east side of Sabina Street commencing at its intersection with Hercules Street and extending in a northerly direction for a distance of 15 metres.
- (b) On the east side of Sabina Street commencing at its intersection with Hercules Street and extending in a southerly direction for a distance of 14.5 metres.
- (c) On the west side of Sabina Street commencing at its intersection with Hercules Street and extending in a northerly direction for a distance of 15 metres.
- (d) On the west side of Sabina Street commencing at its intersection with Hercules Street and extending in a southerly direction for a distance of 15 metres.

**11. MANCHESTER/PURCHAS STREET – PROPOSED “NO STOPPING” RESTRICTION**

The Committee was asked to approve the installation of four sections of broken yellow “no stopping” lines on the corner of Manchester Street and Purchas Street.

The Committee **resolved:**

To approve the stopping of vehicles being prohibited at any time:

**(a) Purchas Street**

- (i) On the south side of Purchas Street commencing at its intersection with Manchester Street and extending in a westerly direction for 9.0 metres be revoked.

11. Cont'd

- (ii) On the north side of Purchas Street commencing at its intersection with Manchester Street and extending in an easterly direction for 10.0 metres be revoked.
- (iii) On the south side of Purchas Street commencing at its intersection with Manchester Street and extending in a westerly direction for a distance of 15 metres.
- (iv) On the south side of Purchas Street commencing at its intersection with Manchester Street and extending in an easterly direction for a distance of 15 metres.
- (v) On the north side of Purchas Street commencing at its intersection with Manchester Street and extending in an easterly direction for a distance of 15 metres.
- (vi) On the north side of Purchas Street commencing at its intersection with Manchester Street and extending in a westerly direction for a distance of 15 metres.

(b) **Manchester Street**

- (i) On the east side of Manchester Street commencing at its intersection with Purchas Street and extending in a southerly direction for a distance of 15 metres.
- (ii) On the east side of Manchester Street commencing at its intersection with Purchas Street and extending in a northerly direction for a distance of 15 metres.
- (iii) On the west side of Manchester Street commencing at its intersection with Purchas Street and extending in a southerly direction for a distance of 15 metres.
- (iv) On the west side of Manchester Street commencing at its intersection with Purchas Street and extending in a northerly direction for a distance of 15 metres.

12. **RISELAW STREET – PROPOSED “NO STOPPING” RESTRICTION**

The Committee was asked to approve the installation of a section of broken yellow “no stopping” lines on the north side of Riselaw Street.

The Committee **resolved** to approve the stopping of vehicles being prohibited at all times on the north side of Riselaw Street commencing from the east boundary of 16 Riselaw Street and extending in a easterly direction for a distance of 30 metres.

13. **WATERFORD AVENUE – PROPOSED “NO STOPPING” RESTRICTION**

The Committee was asked to approve the installation of a section of broken yellow “no stopping” lines on Waterford Avenue.

The Committee **resolved** to approve the stopping of vehicles being prohibited at all times on the east side of Waterford Avenue commencing at a point 96 metres south of its intersection with Northwood Boulevard and extending in a counter clockwise direction for a distance of 125 metres around the bend.

The meeting concluded at 6.02 pm.

**CONFIRMED THIS 16TH DAY OF JUNE 2008**

**MATT MORRIS  
CHAIRPERSON**

**3. DEPUTATIONS BY APPOINTMENT**

**3.1 BELFAST ROTARY GROUP – TOTARA AWARD SCHEME**

A representative from Belfast Rotary Group will be in attendance to brief the Board on the Totara Award Scheme.

**4. UPDATE FROM THE CONTRACTS AND MAINTENANCE TEAM**

- Speed Trailer results Vagues Road
- Styx Bridge update
- Redwood Library issue (parking restrictions, signage for pedestrians etc.)
- Springfield Road/Abberley Crescent/Edgeware Road traffic management plan
- Mary Street one-way proposal for Main North Road Junction
- Sawyers Arms/Gardiners Road intersection traffic concerns
- Roosevelt Avenue - feedback on speed trailer results
- Daniels Road pedestrian crossing at Main North Road
- Woodchester Street Intersection concerns



**5. BEALEY AVENUE - P5 AT ANY TIME PARKING RESTRICTION**

<b>General Manager responsible:</b>	General Manager City Environment, DDI 941 8608
<b>Officer responsible:</b>	Transport and Greenspace Manager
<b>Author:</b>	Basil Pettigrew, Traffic Engineer

**PURPOSE OF REPORT**

1. The purpose of this report is to seek the Committee's approval to install a parking restriction at the corner of Bealey Avenue and Champion Street.

**EXECUTIVE SUMMARY**

2. The Council has received a request from the owner of the Bealey Avenue Food Market situated on the northwest corner of the Bealey Avenue and Champion Street intersection (refer **attached** diagram) for time restricted parking. They state that customers to their business are continually complaining to them of the lack of available parking in the area, hence they have asked for this parking restriction.
3. An investigation confirmed that commuter parking does prevent parking in close proximity to this business.
4. Support has been obtained from the adjacent property owner in Bealey Avenue to the proposal to install a P5 (At Any Time) Parking Restriction capable of accommodating three vehicles.

**FINANCIAL IMPLICATIONS**

5. The estimated cost of this proposal is \$200.

**Do the Recommendations of this Report Align with 2006-16 LTCCP budgets?**

6. The installation of road markings, signs and a post is within the LTCCP Street and Transport Operational Budgets.

**LEGAL CONSIDERATIONS**

7. The land Transport Rules provide for the installation of parking restrictions.

**Have you considered the legal implications of the issue under consideration?**

8. As above.

**ALIGNMENT WITH LTCCP AND ACTIVITY MANAGEMENT PLANS**

9. Aligns with the Streets and transport activities by contributing to the Council's Community outcomes-Community.

**Do the recommendations of this report support a level of service or project in the 2006-16 LTCCP?**

10. This contributes to improve the level of service for parking.

**ALIGNMENT WITH STRATEGIES**

11. The recommendations align with the Council's Parking Strategy 2003

**Do the recommendations align with the Council's strategies?**

12. As above.

**5. Cont'd**

**CONSULTATION FULFILMENT**

13. Consultation with the affected property owner has been undertaken.

**STAFF RECOMMENDATION**

It is recommended that the Greenspace Traffic Works Committee approve that the parking of vehicles be restricted at any time, to a maximum period of five minutes on the north side of Bealey Avenue commencing at a point 9.5 metres west of its intersection with Champion Street and extending in a westerly direction for a distance of 20.5 metres.

**CHAIRPERSON'S RECOMMENDATION**

That the staff recommendation be adopted.



© Copyright Christchurch City Council © Aerial Photography Copyright Terraflink International Ltd



**BEALEY AVENUE**  
P5 Parking Restriction  
**For Board Approval**

Original Plan Size: A4  
ISSUE.1 18/04/08  
TG034821 MCD

## 6. THE YOUNG TOTARA AWARD

<b>General Manager responsible:</b>	General Manager City Environment DDI 941-8608
<b>Officer responsible:</b>	Asset and Network Planning
<b>Author:</b>	Christine Heremaia, Parks and Waterways Planner

### PURPOSE OF REPORT

1. The purpose of this report is to seek approval from the Board for an area of land to be set aside at Styx Mill Conservation Reserve for the planting of totara trees. These trees will recognise outstanding young people in the local community as part of "The Young Totara Award" organised by the Belfast Rotary Club.

### EXECUTIVE SUMMARY

2. The Belfast Rotary Club approached the Christchurch City Council for an area of reserve that could be used to plant totara trees to recognise the achievements of outstanding young people in the local area. A suitable site was selected at Styx Mill Conservation Reserve by representatives of the Belfast Rotary Club and Council staff.
3. A detailed layout plan and management requirements have been developed for this area. With each award a tree will be planted in this area creating, in the long term, a totara forest. The area will be developed by members of the Belfast Rotary Club

### FINANCIAL IMPLICATIONS

4. There are no financial implications.

### Do the Recommendations of this Report Align with 2006-16 LTCCP budgets?

5. Not applicable.

### LEGAL CONSIDERATIONS

6. The proposal is consistent with the City Plan, Styx Vision 2000 – 2040, and the long term vision for Styx Mill Conservation Reserve.

### Have you considered the legal implications of the issue under consideration?

7. There are no legal implications.

### ALIGNMENT WITH LTCCP AND ACTIVITY MANAGEMENT PLANS

8. The recommendations of this report align with 2006–16 LTCCP and activity management plans.

### Do the recommendations of this report support a level of service or project in the 2006-16 LTCCP?

9. Yes, they support the implementation of the long term development plan for Styx Mill Conservation Reserve.

### ALIGNMENT WITH STRATEGIES

10. The project is aligned with the "Styx Vision 2000 – 2040".

### Do the recommendations align with the Council's strategies?

11. The project is consistent with the following strategic directions - strong communities, healthy environment.

**6. Cont'd**

**CONSULTATION FULFILMENT**

12. The vision for Styx Mill Conservation Reserve was consulted on and approved by the Council. This development is consistent with that plan. Council staff have also worked closely with representatives from the Belfast Rotary Club in the identification of an area and development of a detailed plan that would fulfil the requirements of the long term vision for the reserve and the Rotary Club's specific requirements.

**STAFF RECOMMENDATION**

It is recommended that the Greenspace Traffic Works Committee support and approve the setting aside of an area of land at the Styx Mill Conservation Reserve as outlined in the report, for the planting of totara trees in recognition of outstanding young people within the local community.

**CHAIRPERSON'S RECOMMENDATION**

For discussion.

6. Cont'd

**BACKGROUND**

13. The 'Young Totara Award' is a national programme that has been initiated locally by the Rotary Club of Belfast. This award acknowledges outstanding young people in the local area under the age of 21. Each year, depending on the availability of a suitable candidate, a young person is selected by the Rotary Club for this award. To date, eight presentations have been made.
14. The Belfast Rotary Club approached the Christchurch City Council for an area of reserve where each year a totara tree could be planted to commemorate a young person and the overall award scheme. A number of sites were investigated with an area at Styx Mill Conservation Reserve being identified by members of the Belfast Rotary Club and Christchurch City Council staff as being the most appropriate.

**THE OBJECTIVES**

15.
  - (a) To acknowledge the achievements of outstanding young people in the area.
  - (b) To provide a long term visual marker that highlights the 'Young Totara Award' scheme to the wider community.
  - (c) To add benefit to the natural environment through the development of a totara forest.

**DETAILS OF THE PROPOSALS**

16. The planting of totara trees will occur in an area bordering the southern boundary of the asphalt carpark near the existing toilet block at Styx Mill Conservation Reserve. This area is currently a large grass area surrounded by a border of trees approximately 14 years old.



Photo of area to be planted in totara trees.

17. The planting of trees in this area is consistent with the long term vision for Styx Mill Conservation Reserve.



6. Cont'd

18. The area will enable the planting of approximately 60 totara trees. Planting specifications and a detailed site plan of how this area will be planted is **attached** as Appendix 1 and 2.
19. The Belfast Rotary Club, will:
  - each year provide and plant a totara tree in accordance with the detailed site plan and management specifications.
  - accept responsibility for the care and upkeep of these trees for a 12 month establishment period following planting.
  - replace any trees that may become vandalised, diseased, or die.
  - provide a suitable sign acknowledging the purpose of this area.
20. In undertaking this activity, the club will liaise closely with Council staff in the planting and management of the trees and the design of the sign.
21. In order to limit signage on site, and avoid the need to each year add a new name to the sign, information about the scheme and the young persons winning awards will be provided on the Styx website. This web site is currently being updated.
22. There will be no extra costs (capital, operating) to Council associated with this proposal.
23. In the unlikely event that the award scheme is discontinued, then the Council will complete the planting in this area.

**ASSESSMENT OF OPTIONS****The Preferred Option**

24. To set aside an area at Styx Mill Conservation Reserve for the planting of totara trees to acknowledge outstanding young people under the age of 21 years.

	<b>Benefits (current and future)</b>	<b>Costs (current and future)</b>
<b>Social</b>	Long term visible recognition of outstanding young people in the community. Partnership with a local long standing community group	
<b>Cultural</b>		
<b>Environmental</b>	Planting of totara trees will add to the biodiversity values of the area.	
<b>Economic</b>	No cost to the Council	
<p><b>Extent to which community outcomes are achieved:</b></p> <p>A city of inclusive and diverse communities A city of people who value and protect the natural environment</p> <p><b>Impact on the Council's capacity and responsibilities:</b></p> <p>No impact on council's capacity and responsibilities</p> <p><b>Effects on Maori:</b></p> <p>Nil</p> <p><b>Consistency with existing Council policies:</b></p> <p><b>Policy : Public Participation</b></p> <p>11.6.3 To encourage public participation and involvement of community groups in identifying areas for neighbourhood improvement and formulating and implementing programmes to improve these areas.</p> <p><b>Views and preferences of persons affected or likely to have an interest:</b></p> <p>Members of the Belfast Rotary Club support the initiative.</p> <p><b>Other relevant matters:</b></p> <p>Nil.</p>		



**Maintain the Status Quo (if not preferred option)**

25. Not to set aside an area at Styx Mill Conservation Reserve for the planting of totara trees to acknowledge outstanding young people under the age of 21 years.

	<b>Benefits (current and future)</b>	<b>Costs (current and future)</b>
<b>Social</b>		Lost opportunity to recognise young people in the community
<b>Cultural</b>		
<b>Environmental</b>		
<b>Economic</b>		In implementing the long term vision for Styx Mill Conservation Reserve, the council will have to pay for the cost as these trees

**Extent to which community outcomes are achieved:**

The following community outcomes will not be achieved -  
 A city of inclusive and diverse communities  
 A city of people who value and protect the natural environment

**Impact on the Council's capacity and responsibilities:**

Adds to council costs as the council will now have to pay for the cost of these trees when this section of the long term plan for Styx Mill Conservation Reserve is implemented.

**Effects on Maori:**

Nil.

**Consistency with existing Council policies:**

This decision does not support public participation and involvement of community groups in identifying areas for neighbourhood improvement and formulating and implementing programmes to improve these areas.

**Views and preferences of persons affected or likely to have an interest:**

Members of the Belfast Rotary Club will be disappointed.

**Other relevant matters:**

Nil.

Appendix One

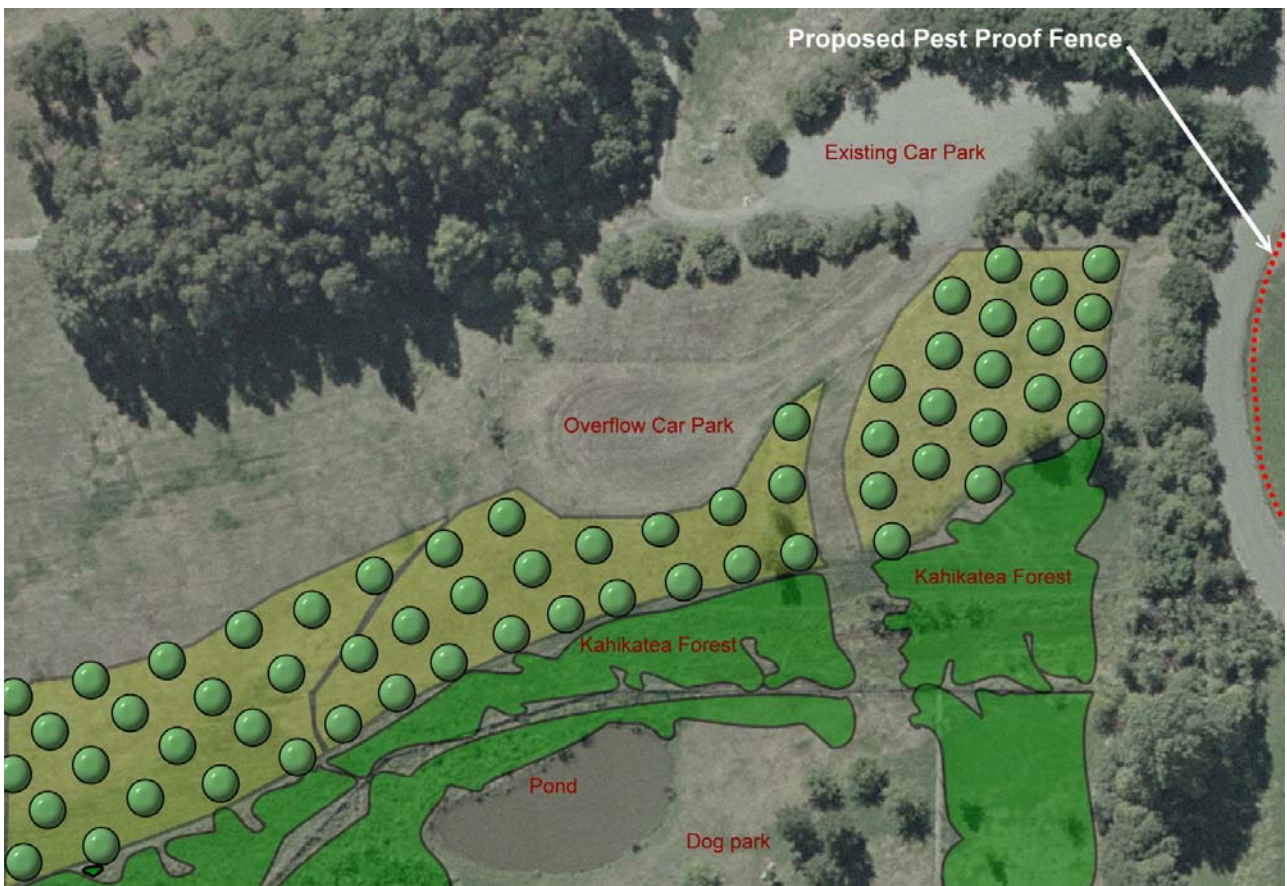
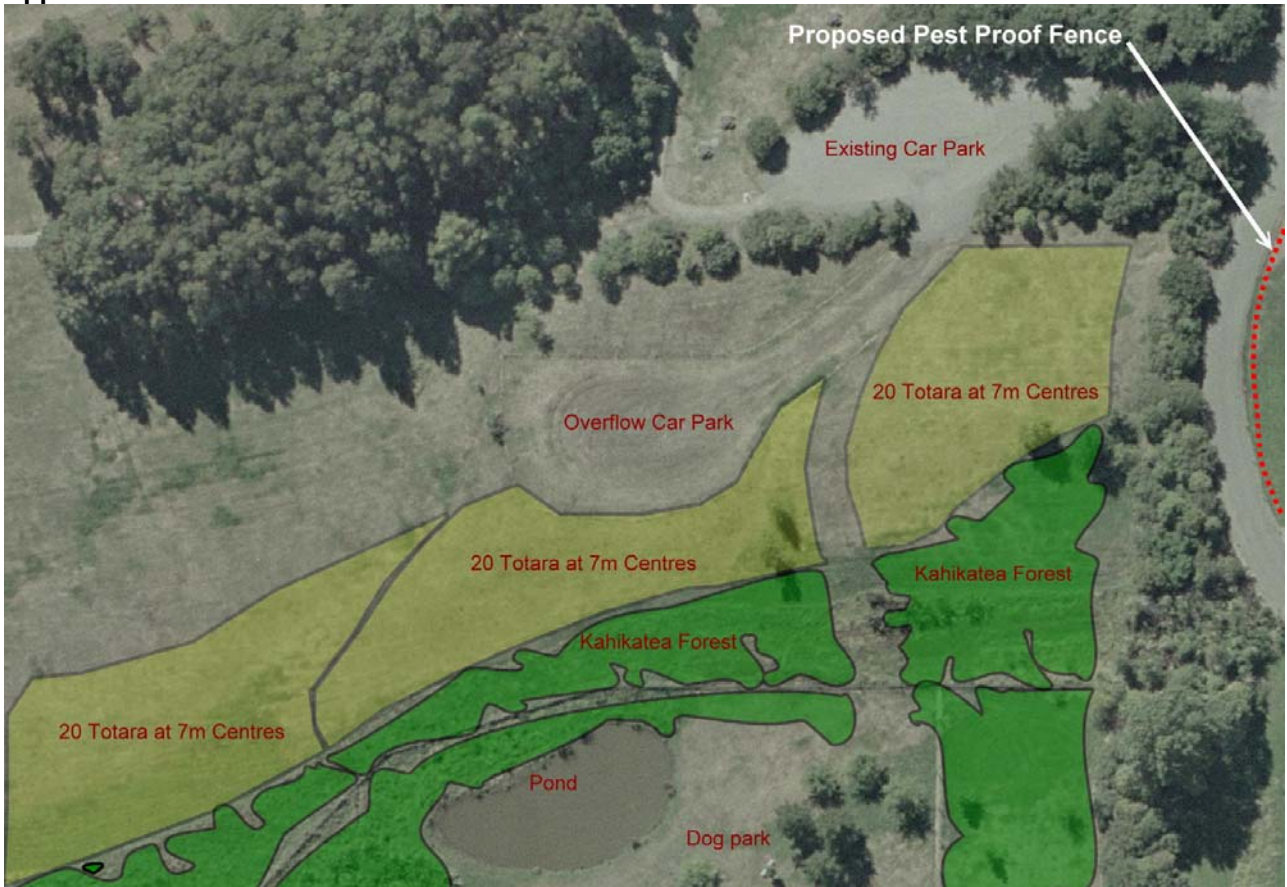

**Appendix Two**

**MANAGEMENT REQUIREMENTS**

- 1) Totara trees will be of locally sourced genetic origin ex Christchurch City Council Harewood Nursery or other Christchurch City Council approved supplier
- 2) Trees will be containerised, two metres in height and in (eg) 60 litre or equivalent containers.
- 3) Trees will be planted in tree pits as per the relevant clauses of Christchurch City Council CSS Part 7 (Landscape).
- 4) Trees will be staked to Christchurch City Council CSS SD701 (diagonal tree staking).
- 5) Belfast Rotary shall ensure each tree is maintained and watered for a 12 month establishment period following planting, after which time Christchurch City Council shall carry out any required maintenance on the trees/woodlot area.

16. 6. 2008

- 20 -

**7. COMMITTEE MEMBERS' INFORMATION EXCHANGE**