



Christchurch City Council

FENDALTON/WAIMAIRI COMMUNITY BOARD AGENDA

WEDNESDAY 2 JULY 2008

8AM

IN THE BOARDROOM
FENDALTON SERVICE CENTRE
CORNER JEFFREYS AND CLYDE ROADS

Community Board: Val Carter (Chairperson), Cheryl Colley (Deputy Chairperson), Sally Buck, Faimeh Burke, Jamie Gough, Mike Wall and Andrew Yoon

Acting Community Board Adviser
Graham Sutherland
Phone 941 6728 DDI
Email: graham.sutherland@ccc.govt.nz

PART A - MATTERS REQUIRING A COUNCIL DECISION
PART B - REPORTS FOR INFORMATION
PART C - DELEGATED DECISIONS

INDEX	PG NO		
PART B	2	1.	APOLOGIES
PART C	2	2.	CONFIRMATION OF MEETING REPORT – BOARD MEETING OF 17 JUNE 2008
PART A	8	3.	WAIRAKEI ROAD/AORANGI ROAD INTERSECTION KERB AND DISH CHANNEL RENEWAL
PART C	13	4.	YOUTH IN LOCAL GOVERNMENT CONFERENCE 2008

1. **APOLOGIES**

Cheryl Colley.

2. **CONFIRMATION OF MEETING REPORT – 17 JUNE 2008**

The report of the Board's ordinary meeting of 17 June 2008 is **attached**.

CHAIRPERSON'S OR STAFF RECOMMENDATION

That the report of the Board's ordinary meeting be confirmed.

2. 7. 2008

- 3 -

ATTACHMENT TO CLAUSE 2

14. 8. 2008

**FENDALTON/WAIMAIRI COMMUNITY BOARD
17 JUNE 2008**

**A meeting of the Fendalton/Waimairi Community Board
was held on Tuesday 17 June 2008 at 4pm
in the Board Room, Fendalton Service Centre.**

PRESENT: Val Carter (Chairperson), Sally Buck, Faimeh Burke, Cheryl Colley,
Jamie Gough, Mike Wall and Andrew Yoon.

APOLOGIES: Nil.

The Board reports that:

PART B – REPORTS FOR INFORMATION

1. 10 WAIWETU STREET – DISPOSAL OF SURPLUS LAND

A Part A report was submitted to the Board regarding a request by a resident of Waiwetu Street to purchase a strip of legal road outside their property. The report recommended that the Board recommend to Council that the land in question be declared surplus for disposal and offered for sale to the adjoining owner.

The Board **decided** to leave the report to lie on the table, pending a decision from the Council on the disposal of surplus land matter concerning 173 Clyde Road, which was deferred by the Council at its meeting on 12 June 2008.

2. DEPUTATIONS BY APPOINTMENT

2.1 TELUSA VEANIU

Telusa Veaniu received a Youth Development Fund grant from the Board to compete in the New Zealand Touch Nationals in Wanganui as a member of the Canterbury Under 19 Boys Team. Telusa spoke to the Board about his experiences and reported that his team won the tournament. Telusa thanked the Board for its support.

2.2 NICKI MCFADZIEN

Nicki McFadzien received a Youth Development Fund grant from the Board to represent New Zealand as a member of the secondary schools cross country team in the World Schools Cross Country Championships in the Czech Republic in April 2008. Nicki spoke to the Board about her experiences and reported that she finished fourth in her event and her team finished first overall. Nicki thanked the Board for its support.

3. PRESENTATION OF PETITIONS

Nil.

4. NOTICES OF MOTION

Nil.

ATTACHMENT TO CLAUSE 2

5. CORRESPONDENCE

Nil.

6. BRIEFINGS

Nil.

7. COMMUNITY BOARD ADVISER UPDATE

The Board **received** an update from the Community Board Adviser on forthcoming Board related activity over the coming weeks and on the status of the Board's funds.

8. ELECTED MEMBERS' INFORMATION EXCHANGE

Board members were provided with an opportunity to share issues of concern and in particular Sally Buck updated the Board with respect to the Council's submission on the Fencing of Swimming Pools Act Discussion Document.

PART C – DELEGATED DECISIONS TAKEN BY THE BOARD

9. CONFIRMATION OF MEETING REPORT – 4 JUNE 2008

The Board **resolved** that the reports of the Board's meeting of 4 June 2008 (both open and public excluded) be confirmed as true and accurate records of the meeting.

10. WORKS, TRAFFIC AND ENVIRONMENT COMMITTEE MEETING – REPORT OF 26 MAY 2008

The Board considered the report of its Works, Traffic and Environment Committee meeting of 26 May 2008 and **resolved**:

1. Ray Blank Park Tree Replacement Planting Plan

That the Board:

- (a) Approve the Ray Blank Park Major Tree Replacement Planting Plan, as detailed in the report to the committee.
- (b) Approve the Capital Programme Group to commence implementation of the approved plan.

2. Signalised Crossings Bishopdale and Westburn Primary Schools

That the Board:

- (a) Receive the information from staff regarding the feasibility and costs of signalised crossings outside Bishopdale and Westburn Primary Schools.
- (b) Recommend to the Council that funding be increased to upgrade school crossing facilities citywide in the 2009-19 Long Term Council Community Plan (LTCCP).
- (c) Recommend to the Council that the signalised crossings for Bishopdale and Westburn Schools, as recommended in the attached Via Strada report, be included in the LTCCP to be implemented as quickly as possible, with first priority given to Westburn Primary School and second priority to Bishopdale Primary School.

10. Cont'd

3. **Knowles Street (Papanui Road - Bretts Road) Street Renewal Project - St Albans Creek Enhancement**

That the Board approve the plan (shown in attachment 1 to the report to the Committee) referred to as the Fencing and Viewing Option, to proceed to final design, tender and construction.

11. **COMMUNITY SERVICES COMMITTEE MEETING – REPORT OF 4 JUNE 2008**

The Board considered the report of its Community Services Committee meeting of 4 June 2008 and a Board Funding Update memorandum dated 17 June 2008 from the Community Board Adviser identifying further unspent Board funds, and **resolved**:

1. **2007/08 Project and Discretionary Funding – Allocation of Remaining Funds**

That the Board:

- (a) Approve the transfer of the remaining \$3,336 from the Community Board Planning Report project to the Discretionary Fund for reallocation.
- (b) Approve the transfer of the remaining \$3,973 from the Heritage Awards project to the Discretionary Fund for reallocation.
- (c) Approve the transfer of the remaining \$1,108 from the Neighbourhood Week project to the Discretionary Fund for reallocation.
- (d) Approve the transfer of the remaining \$1,300 from the Community Pride Garden Awards project to the Discretionary Fund for reallocation.
- (e) Approve the transfer of \$700 from the Discretionary Fund to the Youth Development Fund to cover the Youth Development grants approved as detailed in the table below:

Thomas Davis	Travel to the United Kingdom in July to attend workshops, talkshops, productions, a Shakespeare rally, and to be taught by a Globe Education Director on 'A Midsummer Night's Dream' culminating in a public performance on The Globe Stage.	\$600
Nieka George	To attend a six-day Girl Guide Summer Camp in July 2008, followed by an eight-day International Girl Scout Camporee.	\$600
Michael Vink	To compete in the 2008 World Junior Track & Road Cycling Championships being held in South Africa, in July 2008.	\$600

- (f) Approve the remaining unspent Board funds of \$1,533, as identified in the memorandum from the Community Board Adviser, to be added to the Committee's recommended amount of \$5,000 for the Aorangi Primary School Diamond Project, to increase that allocation to a total of \$6,533.
- (g) Following the decisions in (a) to (f) above, approve the allocations from the 2007/08 Discretionary Fund, as detailed in the table below:

GROUP/ORGANISATION	PROGRAMME	AMOUNT (\$)
Big Brothers Big Sisters of Christchurch	Youth Mentoring Programme.	3,900
Kiwanis Club of Waimairi	Terrific Kids Awards.	300
YMCA Bishopdale	Installation of security cameras in Bishopdale YMCA carpark.	8,000
Breens Intermediate School	Extension of Harakeke Garden.	2,000
Merivale Precinct Society	Annual House Awards.	2,000
Presbyterian Support	Aorangi School Project Coordinator.	4,500
Aorangi Primary School	Diamond Project.	6,533

(Faimeh Burke declared a conflict of interest with respect to the funding application for the Merivale Precinct Society and took no part in the discussion or voting on this matter.)

2. Fendalton/Waimairi Small Projects Fund Assessment Committee 2008-2010

That the Board:

- (a) Establish the Fendalton/Waimairi Small Projects Fund Assessment Committee with the following Terms of Reference:
 - (i) To recommend to the Community Board allocations for the "Small Projects Fund – Local" in line with Council Policy and the LTCCP.
 - (ii) To consist of all Community Board members with a term of three years, for the 2008-09, 2009-10 and 2010-11 funding rounds.
 - (iii) To include four community representatives with an initial term of two years for the 2008-09 and 2009-10 funding rounds.
- (b) Appoint all Fendalton/Waimairi Community Board members to the Fendalton/Waimairi Small Projects Fund Assessment Committee for the funding rounds 2008-09, 2009-10 and 2010-11.
- (c) Approve the following community representatives to be members of the Fendalton/Waimairi Small Projects Fund Assessment Committee for the period June 2008 to May 2010:
 - Edward David Moyle
 - Lex Telfer
 - Edward William Cropley
 - Vicki Maree O'Grady.
- (d) Allow the Fendalton/Waimairi Small Projects Fund Assessment Committee to appoint a chairperson and deputy chairperson at its first meeting.
- (e) Set a quorum of five members, one of whom must be an elected member.

2. 7. 2008

- 7 -

ATTACHMENT TO CLAUSE 2

12. KEEP NEW ZEALAND BEAUTIFUL CONFERENCE

The Board considered a report seeking a Board decision on whether or not to approve funding for a Board member to attend the Keep New Zealand Beautiful Conference and Annual General Meeting in Dunedin and **resolved:**

That the Board approve funding for Jamie Gough to attend the Keep New Zealand Beautiful Conference in Dunedin from 19 to 21 September 2008.

The meeting concluded at 4.45pm.

CONFIRMED THIS 2nd DAY OF JULY 2008

**VAL CARTER
CHAIRPERSON**

3. WAIRAKEI ROAD/AORANGI ROAD INTERSECTION KERB AND DISH CHANNEL RENEWAL

General Manager responsible:	General Manager City Environment Group, DDI 941 6401
Officer responsible:	Acting Transport and Greenspace Manager,
Author:	David Pinkney, Project Manager

PURPOSE OF REPORT

1. The purpose of this report is to:
 - (a) Respond to the four resolutions made by Council when it considered the Wairakei Road - Stage 1 report of July 2007.
 - (b) Seek Board comment and Council approval for the proposed works at the Wairakei/Aorangi Roads intersection, to proceed to implementation and construction.
 - (c) Seek Board comment and Council approval for the new parking and traffic resolutions.
2. This report was considered by the Fendalton/Waimairi Works, Traffic & Environment Committee on 23 June 2008 and is being forwarded to this Board meeting, separate from the rest of the Committee report, to minimise further delays with the project.

EXECUTIVE SUMMARY

3. The Wairakei/Aorangi Roads intersection was part of a set of integrated projects covering Blighs and Wairakei Roads in the Christchurch City Council's Capital Works Program in the 2006/07, 2007/08, and 2008/09 financial years. This section of Wairakei Road is classified as a minor arterial road and as such requires a Council decision.
4. The original concept for Wairakei Road Stage 1 (including the Aorangi Road intersection) was developed from community and technical objectives and included flush medians, pedestrian islands, traffic and cycle lanes, and parking spaces. Landscaping and trees were included where opportunities allowed. The Council meeting on the 5 July 2007 resolved:
 - "a) *To approve the proposal shown on **attachment 1** for construction, with the exception of the proposed redesign of the Aorangi Road/Wairakei Road intersection.*
 - b) *That no changes be made at the present time to the existing layout of the Aorangi Road/Wairakei Road intersection and that staff are requested to report back on other measures which could be taken to improve traffic safety at this intersection.*
 - c) *That a 40 kilometre per hour school slow zone be installed outside Wairakei Road School at the same time that the upgrading work is implemented, and that staff investigate the possibility of extending this zone to the Aorangi Road intersection.*
 - d) *That the traffic restrictions recommended in the staff report be approved, with the exception of the restrictions proposed in respect of Right Turn or Straight Through Movements at the Aorangi Road/Wairakei Road intersection."*
5. This report responds to the request that staff "report back on other measures which could be taken to improve traffic safety at this intersection" *note 3b and 3c above.*
6. With respect to 3(c) above, a 40 kilometre per hour speed zone cannot be supported for Wairakei School, or extended to Aorangi intersection for the following reasons:
 - The bulk of school children use the crossing point at Greers/Wairakei intersection to access the south side of Wairakei Road. The number of children using the secondary entrance near Manor Place is not sufficient to warrant a 40 kilometre per hour speed zone under guidelines set down by Land Transport New Zealand.

3. Cont'd

- These guidelines also specify the total length of carriageway over which temporary speed restrictions can be enforced. The distance from the school to the Aorangi intersection greatly exceeds these guidelines.
- In reference to paragraph 3(b) above, slight changes have been made to the south-east and south-west kerb alignments to allow the inclusion of cycle lanes through this intersection. Additional pedestrian barriers will be added at all islands along with tactile pavers.
- The two trees on the north-east corner will need to be removed due to sightline issues.

FINANCIAL IMPLICATIONS

7. None, this work is within the previously approved project budget.

Do the Recommendations of this Report Align with 2006-16 LTCCP budgets?

8. The option recommended in this report aligns with the 2006-16 LTCCP budgets (see above details).

LEGAL CONSIDERATIONS

9. A Council resolution is required to implement the parking restriction changes to the Wairakei/Aorangi intersection. This resolution is item (vi) in "Staff Recommendations" below.

Have you considered the legal implications of the issue under consideration?

10. There are no legal implications other than the required parking resolutions as noted in clause 9. This report's recommendations support the project objectives as outlined in the 2006-16 LTCCP.

ALIGNMENT WITH LTCCP AND ACTIVITY MANAGEMENT PLANS

Do the recommendations of this report support a level of service or project in the 2006-16 LTCCP?

11. Yes this report's recommendations align with the Transport and Greenspace Unit's Asset Management Plan and the Street Renewals Projects section of the Capital Works Programme, page 85.

ALIGNMENT WITH STRATEGIES

Do the recommendations align with the Council's strategies?

12. The option reported does not align with Council strategies including the Christchurch Road Safety Strategy, Pedestrian Strategy and Cycling Strategy.

CONSULTATION FULFILMENT

13. Extensive consultation involving surveys, newsletters, site meetings, property visits and public meetings identified there is significant support for the proposed layout of the intersection from the community. Many Aorangi Road and Colwyn Street residents objected strongly to proposals involving the loss of the through traffic movement along Aorangi Road; and right turn onto Wairakei Road from Aorangi Road on the grounds of cost in terms of time and extra mileage on their vehicles. These residents feel the safety benefits, which would result if the staff proposal was accepted, are not justified.

3. Cont'd

STAFF RECOMMENDATION

Other than options already presented to and rejected by Council, only minimal improvements to the existing layout can be made to improve safety for straight through and right turners from Aorangi Road so the existing alignment should remain as per Plan TP 172707, shown as **attachment 1** to this report. It is therefore recommended that the Board recommend that the Council:

- (a) Approve the proposal, as shown on **attachment 2**, for construction.
- (b) Approve the following traffic restrictions for installation:

Removal of existing "No Stopping":

- (i) That the existing no stopping be revoked on both sides of Wairakei Road from 50 metres west of Aorangi Road to 50 metres east of Aorangi Road.

New "No Stopping": Wairakei Road

- (ii) That the stopping of vehicles be prohibited at any time on the north side of Wairakei Road commencing at its intersection with Aorangi Road and extending 18 metres in a westerly direction.
- (iii) That the stopping of vehicles be prohibited at any time on the north side of Wairakei Road commencing at its intersection with Aorangi Road and extending 27 metres in an easterly direction.
- (iv) That the stopping of vehicles be prohibited at any time on the south side of Wairakei Road commencing at its intersection with Aorangi Road and extending 17 metres in a westerly direction.
- (v) That the stopping of vehicles be prohibited at any time on the south side of Wairakei Road commencing at its intersection with Aorangi Road and extending 35 metres in an easterly direction.
- (vi) That the existing single car park on the south side of Wairakei Road, outside number 169, is retained as is.

WORKS, TRAFFIC & ENVIRONMENT COMMITTEE RECOMMENDATION

That the staff recommendations be adopted.

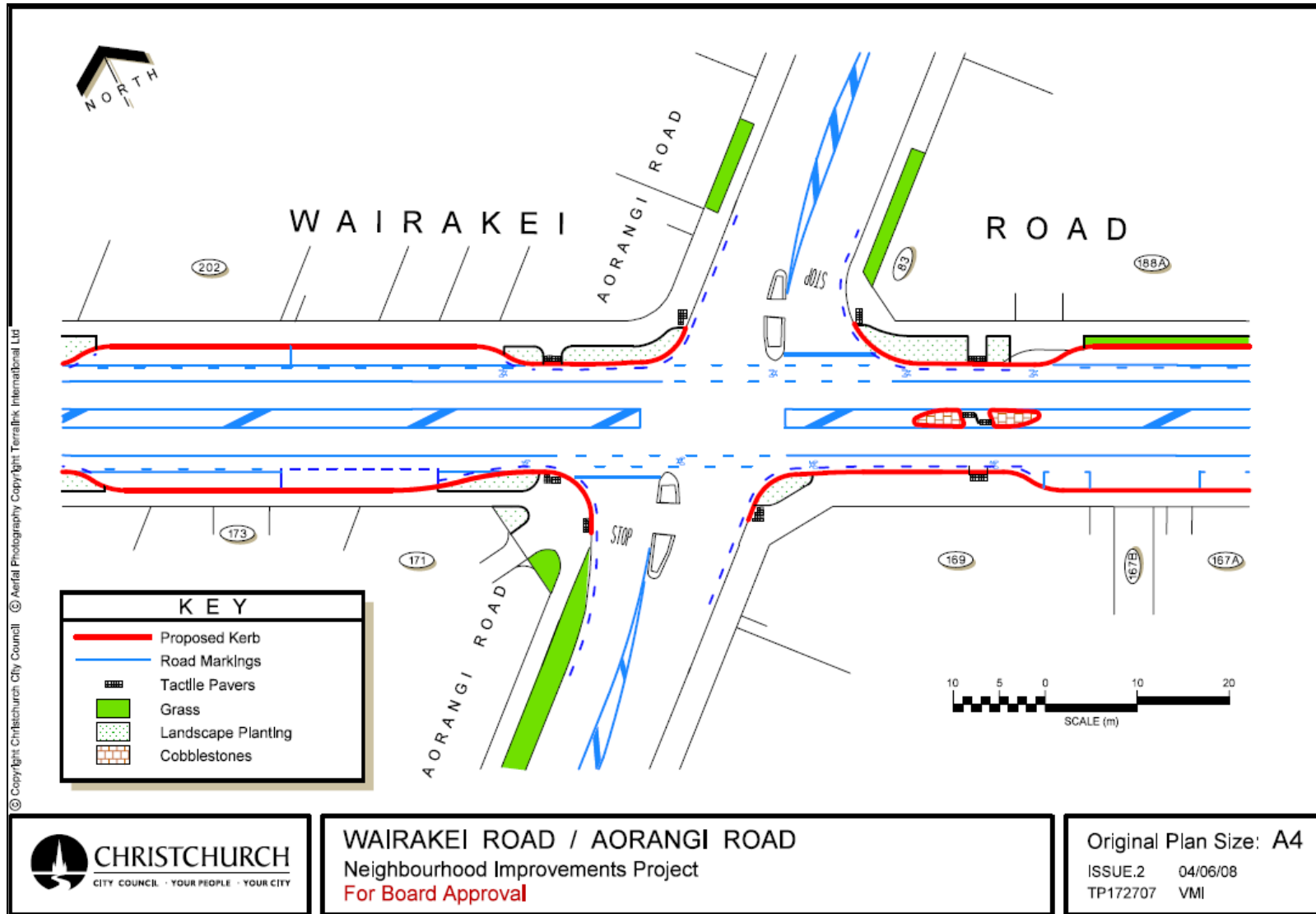

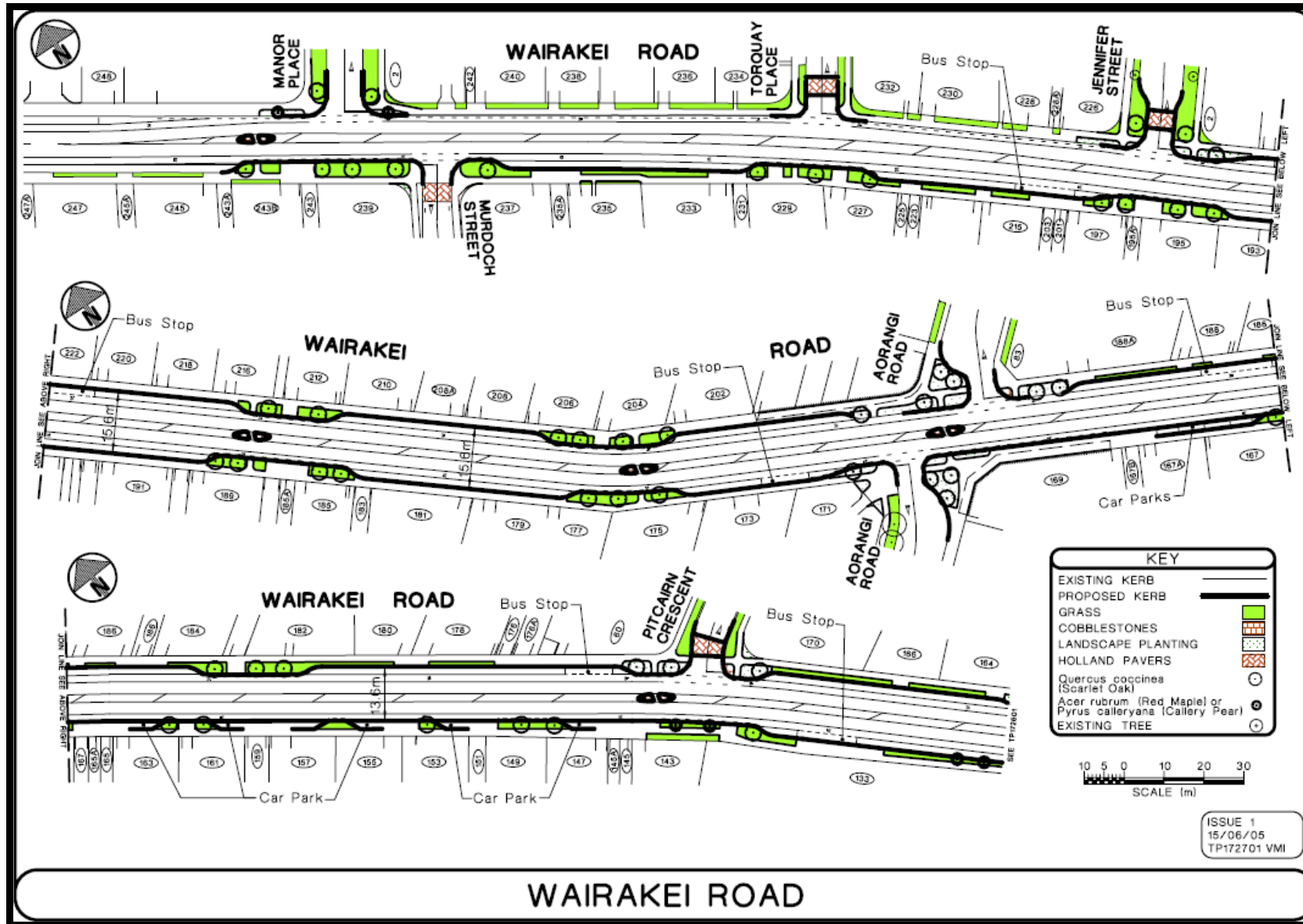

4. YOUTH IN LOCAL GOVERNMENT CONFERENCE 2008

General Manager responsible:	General Manager Regulation and Democracy Services, DDI 941-8462
Officer responsible:	Democracy Services Manager
Author:	Graham Sutherland, Acting Community Board Adviser

PURPOSE OF REPORT

1. The purpose of this report is for the Board to decide whether or not to approve funding for a Board member or members to attend the Youth in Local Government Conference in Christchurch from 6 to 8 October 2008.

EXECUTIVE SUMMARY

2. Christchurch City Council is hosting the Youth in Local Government Conference this year and Jamie Gough has expressed an interest in attending as a representative of the Board.
3. The conference is a biennial event usually attended by mayors, councillors and community board members as well as staff and young people involved in local government. It provides an opportunity for those people working in local government who are interested in developing stronger links with young people to meet together, build networks and discuss issues related to involving young people with their local communities. The theme of the conference this year is Transforming the Future and topics include Growing Active Citizens, Youth Employment and Youth Participation. The conference programme is **attached**.

FINANCIAL IMPLICATIONS

4. The cost for one member to attend would be \$495, which would be met from the Board's operational budget for 2008/09. This would cover conference registration only, as the conference is held in Christchurch. Without pre-empting a decision from the Board on this matter, a tentative booking has been made for one of the limited number of "Young Persons" (18-24) registrations, which is \$295, in the event that the Board approves funding for Jamie Gough to attend.

Do the Recommendations of this Report Align with 2006-16 LTCCP budgets?

5. Yes.

LEGAL CONSIDERATIONS**Have you considered the legal implications of the issue under consideration?**

6. There are no legal considerations.

ALIGNMENT WITH LTCCP AND ACTIVITY MANAGEMENT PLANS**Do the recommendations of this report support a level of service or project in the 2006-16 LTCCP?**

7. Yes. Democracy and Governance Support.

ALIGNMENT WITH STRATEGIES**Do the recommendations align with the Council's strategies?**

8. Yes, Page 59 of the LTCCP, Strategic Direction, Strong Communities.

CONSULTATION FULFILMENT

9. Not applicable.

STAFF RECOMMENDATION

It is recommended that the Board decide whether to approve funding for a Board member to attend the Youth in Local Government Conference in Christchurch from 6 to 8 October 2008.

transforming the future



huringa kētanga o
te wā e heke mai nei

YOUTH IN LOCAL GOVERNMENT | CHRISTCHURCH 2008

6th - 8th October 2008



programme

Monday 6 October - Youth Day

WHO IS YOUTH DAY FOR: youth councillors and other young people who are part of local boards, forums, committees or other advisory groups involved in some way with local government.

11am - 5pm

Youth Day (12 - 24 year olds)

- *Welcome, Mihimihi*
- *Lunch*
- *Introducing the National Youth Council Network*
- *Open Forum for issues facing young people*
- *Skills Session: Presenting to Officials*
- *Meet the Minister of Youth Affairs and Local Government*

Concurrent sessions for Youth Support Staff

- *Supporting your Youth Council – Idea Exchange*
- *Networking Tour of Christchurch Youth Outlets*
- *What works in running Youth Councils*

Tuesday 7 October

8.30am *Powhiri and Mayors Address*

10.30am Morning Tea

11.00am Ministers Address

11.30am *Keynote: Kehinde Bah: [Cultivating Community Leadership](#)*

12.30pm Lunch

1.30pm *Concurrent Seminar One*

Employment		Growing Active Citizens	
Workforce Needs of Canterbury Region		Sustaining the Youth Movement - <i>Kehinde Bah</i>	Growing Active Citizens - <i>Helena Catt, Victoria Owen, Shailer Hart</i>
2.45pm	Afternoon Tea		
3.15pm	<i>Concurrent Seminar Two</i>		
Employment		Growing Active Citizens	
Workforce Needs of Canterbury Region	Dancing with the Stars	Sustaining the Youth Movement - <i>Kehinde Bah</i>	Active Young People in Rotorua - <i>Robert Blaikie</i>
4.30pm	Youth Feedback		
5.00pm	<i>Wrap Up</i>		
7.00pm	Conference Dinner and Awards		
- 12am			

Wednesday 8 October			
7.30am	Breakfast with Keynote Address		
9.15am	Review of Day One		
9.30am	Keynote: Melissa Crockett: Resourceful, Fearless and Cunning <i>- A Contemporary Maori Business Model</i>		
10.30am	Morning tea		
11.00am	Concurrent Seminar Three		
Employment		Growing Active Citizens	
Sustainability through Social Responsibility - Melissa Crockett	Technology in Today's Business World - Hamish House and Andrew Plimmer		Youth Citizens Jury
12.15pm	Lunch		
1.15pm	Concurrent Seminar Four		
Employment		Growing Active Citizens	
Sustainability through Social Responsibility - Melissa Crockett	Technology in Today's Business World - Hamish House and Andrew Plimmer	Connecting Councils	NZ Youth Represent Panel
2.30pm	Panel: How to get young people engaged in Local Government Cr Nick Leggett, Cr Hemi Matenga, Cr Tim Manu , Cr Hayley Wain , Cr Anne Molineus, Cr Solitaire Robertson , Cr Yani Johanson, Mayor Philippa Barriball and Mayor Jono Naylor . Chair Dale Williams		
4.00pm	Close / Poroporoaki		
YOUTH DAY			
<i>*Invitation to Youth Councils, Youth Forums, Boards & Committees*</i>			
<i>I would like to warmly invite each and every young person with initiative or involvement in youth work nationwide to attend a conference we hope will be beneficial for us all. Part of this conference is a full day specifically for us, a National Youth Council Day. We will be introducing the new National Youth Council Network, who you will all get to meet. The Otautahi Youth Council is really looking forward to hosting this event, and will make sure you'll have a great time in our lovely city of Christchurch!</i>			
<i>I hope to see you all in October,</i>			
<i>Gloria Grace Sharplin</i> <i>Chairperson</i> <i>Otautahi Youth Council</i>			
The first day of the conference is aimed specifically for youth councillors and other young people who are part of local boards, forums, committees or other advisory groups involved in some way with local government.			
The day is a chance for young people around the country to get together, network, make new friends, swap ideas and discuss issues specific to young people involved in local government in Aotearoa.			
The Youth Day will also provide a chance for those Local Government staff around the country who are directly involved in youth participation to get together and network. The day will provide the opportunity to learn from each other, present ideas and will ensure plenty of time to discuss issues.			
Time and Venue - Christchurch City Council Chambers, 11am until 5pm.			