

**JOINT REPORT BY THE CHAIRPERSONS OF THE
HAGLEY/FERRYMEAD AND THE SPREYDON/HEATHCOTE COMMUNITY BOARDS**

PART A – MATTERS REQUIRING A COUNCIL DECISION

1. MOORHOUSE AVENUE – NO STOPPING (10PM TO 6AM) RESTRICTION

General Manager responsible:	General Manager City Environment, DDI 941-8656
Officer responsible:	Transport and Greenspace Manager
Authors:	Jeff Owen/Barry Cook, Network Operations and Transport Systems

PURPOSE OF REPORT

1. The purpose of this report is to recommend that the Council install a 'No Stopping' (10pm to 6am) restriction on Moorhouse Avenue from Hagley Avenue to Colombo Street, including the area under the Moorhouse Avenue overbridge. A report was considered by the Spreydon/Heathcote Community Board (with respect to those parts of Moorhouse Avenue which fall within that ward), at its meeting of 19 February 2008, and the Hagley/Ferrymead Community Board at its meeting of 20 February 2008 (with respect to those parts of Moorhouse Avenue which fall within that ward, and those parts falling within the Central City Area under the delegations of the Council).

EXECUTIVE SUMMARY

2. The Hagley/Ferrymead Community Board had a deputation from Mr Dave Alexander of 'Alexanders on Moorhouse' car yard to its 30 January 2008 Board meeting. Mr Alexander updated the Board and once again expressed concerns relating to the ongoing late night antics of groups of youths in Moorhouse Avenue outside and in his car yard. He stated that vandalism and general antisocial behaviour was destroying his and other businesses in Moorhouse Avenue. Other businesses in Moorhouse Avenue share the same concerns.
3. Recently, the Council also had the owner's representative from Harvey Norman Centre express concern over ongoing vandalism issues caused by people congregating under the Moorhouse Avenue overbridge.
4. Initially, Mr Alexander and Mr MacKey from Firestone on the corner of Moorhouse Avenue and Selwyn Street had addressed the Hagley/Ferrymead Community Board on 26 September 2007 concerning the conduct of motorists and associated antisocial behaviour on Moorhouse Avenue over long weekends. They advocated a bylaw to enable enforcement agencies to control the unlawful activities. Senior Sergeant Gordon Spite from the Police also attended and spoke about related issues.
5. It is proposed that a 'No Stopping' parking restriction be applied between the hours of 10pm and 6am in the two areas under the overbridge located at the intersection of Moorhouse Avenue and Colombo Street (see attachment 1) and over the whole length of Moorhouse Avenue between Colombo Street and Hagley Avenue. Currently, the area allows unrestricted parking at night. The proposal is expected to discourage 'boy racers' from the area in an attempt to reduce the current levels of vandalism.
6. The current issues on Moorhouse Avenue are not purely a 'hoon' problem or transport issue. The problem is more likely to be an alcohol related issue where young people park in Moorhouse Avenue just outside the City's alcohol ban area before going to the Inner City night clubs. The proposal is seen as an interim measure until such a time that a strategy on how to deal with anti social behaviour can be developed. The strategy has been requested at a higher level through the General Manager for Strategy and Planning.

1 Cont'd

7. There is no residents association in this area as the area is commercial. It is unknown if there is of any business group covering this area although this request has come from businesses in the area. A leaflet detailing the proposal has been distributed to all affected businesses and stakeholders on Moorhouse Avenue. The outcome of this consultation was presented at the respective Board meetings.
8. It is noted that Cass Street and parts of Colombo Street in Sydenham have the same 'No Stopping' restrictions to help curb vandalism which has proved successful.

FINANCIAL IMPLICATIONS

9. The total cost of this proposal is estimated to be \$5,000.

Do the Recommendations of this Report Align with 2006-16 LTCCP budgets?

10. The installation and removal of road markings and signs is within the LTCCP Street and Transport Operational Budgets.

LEGAL CONSIDERATIONS

11. The Land Transport Rules provide for the installation of parking restrictions.

Have you considered the legal implications of the issue under consideration?

12. As above.

ALIGNMENT WITH LTCCP AND ACTIVITY MANAGEMENT PLANS

13. Aligns with the Streets and Transport activities by contributing to the Council's Community outcomes - Community and Safety.

Do the recommendations of this report support a level of service or project in the 2006-16 LTCCP?

14. This contributes to improve the level of service for safety.

ALIGNMENT WITH STRATEGIES

15. The recommendations align with the Council's Parking Strategy 2003.

Do the recommendations align with the Council's strategies?

16. As above.

CONSULTATION FULFILMENT

17. Consultation has been carried out with all the businesses or stakeholders in Moorhouse Avenue. A leaflet (attached) detailing the proposal has been distributed to all affected businesses and stakeholders on Moorhouse Avenue. The outcome of this consultation was presented at the Board meetings.

STAFF RECOMMENDATION

It is recommended that the Council:

- (a) Approve that the stopping of vehicles be prohibited between the hours of 10pm and 6am on the north side of Moorhouse Avenue commencing at a point 93 metres from the Colombo Street intersection and extending in a westerly direction for a distance of 30 metres.

1 Cont'd

- (b) Approve that the stopping of vehicles be prohibited between the hours of 10pm and 6am on the north side of Moorhouse Avenue commencing at a point 166 metres from the Colombo Street intersection and extending in a westerly direction for a distance of 55.5 metres.
- (c) Approve that the stopping of vehicles be prohibited between the hours of 10pm and 6am on the north side of Moorhouse Avenue commencing at a point 93 metres from the Colombo Street intersection and extending in a westerly direction for a distance of 30 metres.
- (d) Approve that the stopping of vehicles be prohibited between the hours of 10pm and 6am on the north side of Moorhouse Avenue commencing at a point 166 metres from the Colombo Street intersection and extending in a westerly direction for a distance of 55.5 metres.
- (e) Approve that the stopping of vehicles be prohibited between the hours of 10pm and 6am on the north side of Moorhouse Avenue commencing at a point 13 metres from the Durham Street intersection and extending in a westerly direction for a distance of 8 metres.
- (f) Approve that the stopping of vehicles be prohibited between the hours of 10pm and 6am on the north side of Moorhouse Avenue commencing at a point 36 metres from the Durham Street intersection and extending in a westerly direction for a distance of 17 metres.
- (g) Approve that the stopping of vehicles be prohibited between the hours of 10pm and 6am on the north side of Moorhouse Avenue commencing at a point 99 metres from the Durham Street intersection and extending in a westerly direction for a distance of 74 metres.
- (h) Note that the Spreydon/Heathcote Board has approved, subject to the provision that Council monitors the situation on Colombo Street with a view to extending the no stopping area into Colombo Street if this become necessary:
 - (i) That the stopping of vehicles be prohibited on the south side of Moorhouse Avenue between the hours of 10pm and 6am commencing at a point 18.5 metres from the Antigua Street intersection and extending in a westerly direction for a distance of 17 metres.
 - (ii) That the stopping of vehicles be prohibited on the south side of Moorhouse Avenue between the hours of 10pm and 6am commencing at a point 50.5 metres from the Antigua Street intersection and extending in a westerly direction for a distance of 120.5 metres.
 - (ii) That the stopping of vehicles be prohibited on the south side of Moorhouse Avenue between the hours of 10pm and 6am commencing at a point 19 metres from the Stuart Mill Street intersection and extending in a westerly direction for a distance of 42 metres.
 - (iv) That the stopping of vehicles be prohibited on the south side of Moorhouse Avenue between the hours of 10pm and 6am commencing at a point 75.5 metres from the Stuart Mill Street intersection and extending in a westerly direction for a distance of 164.5 metres.
 - (v) That the stopping of vehicles be prohibited on the south side of Moorhouse Avenue between the hours of 10pm and 6am commencing at a point 39 metres from the Selwyn Street intersection and extending in a westerly direction for a distance of 212 metres.
- (i) Note that the Hagley/Ferrymead Board has approved:
 - (i) That the stopping of vehicles be prohibited between the hours of 10pm and 6am on the south side of Moorhouse Avenue commencing at a point 54 metres from the Colombo Street intersection and extending in a westerly direction for a distance of 66 metres.
 - (ii) That the stopping of vehicles be prohibited between the hours of 10pm and 6am on the south side of Moorhouse Avenue commencing at a point 139 metres from the Colombo Street intersection and extending in a westerly direction for a distance of 45 metres.

1 Cont'd

- (iii) That the stopping of vehicles be prohibited between the hours of 10pm and 6am on the south side of Moorhouse Avenue commencing at a point 15 metres from the Durham Street intersection and extending in a westerly direction for a distance of 17 metres.
- (iv) That the stopping of vehicles be prohibited between the hours of 10pm and 6am on the south side of Moorhouse Avenue commencing at a point 68 metres from the Durham Street intersection and extending in a westerly direction for a distance of 31 metres.
- (v) That the stopping of vehicles be prohibited between the hours of 10pm and 6am on the south side of Moorhouse Avenue commencing at a point 8 metres from the Orbell Street intersection and extending in a westerly direction for a distance of 56 metres.
- (vi) That the stopping of vehicles be prohibited between the hours of 10pm and 6am on the south side of Moorhouse Avenue commencing at a point 33 metres from the Montreal Street intersection and extending in a westerly direction for a distance of 114 metres.
- (vii) That the stopping of vehicles be prohibited between the hours of 10pm and 6am on the north side of Moorhouse Avenue commencing at a point 50 metres from the Montreal Street intersection and extending in a westerly direction for a distance of 55 metres.
- (viii) That the stopping of vehicles be prohibited between the hours of 10pm and 6am on the north side of Moorhouse Avenue commencing at a point 21 metres from the St David Street intersection and extending in a westerly direction for a distance of 46.5 metres.
- (ix) That the stopping of vehicles be prohibited between the hours of 10pm and 6am on the north side of Moorhouse Avenue commencing at a point 43 metres from the Antigua Street intersection and extending in a westerly direction for a distance of 168.5 metres.
- (x) That the stopping of vehicles be prohibited between the hours of 10pm and 6am on the north side of Moorhouse Avenue commencing at a point 223.5 metres from the Antigua Street intersection and extending in a westerly direction for a distance of 16 metres.
- (xi) That the stopping of vehicles be prohibited between the hours of 10pm and 6am on the north side of Moorhouse Avenue commencing at a point 5.5 metres from the Stewart Street intersection and extending in a westerly direction for a distance of 34.5 metres.
- (xii) That the stopping of vehicles be prohibited between the hours of 10pm and 6am on the north side of Moorhouse Avenue commencing at a point 18.5 metres from the Waller Terrace intersection and extending in a westerly direction for a distance of 93 metres.
- (xiii) That the stopping of vehicles be prohibited between the hours of 10pm and 6am on the north side of Moorhouse Avenue commencing at a point 35 metres from the Selwyn Street intersection and extending in a westerly direction for a distance of 186.5 metres.

and

- (xiv) That the area also be a tow away zone.
- (xv) That staff liaise with Police and report back to the Board three months after the implementation of the no stopping zone with respect to its effect, and particularly regarding displacement of the issue to other areas, especially within the four avenues.

HAGLEY/FERRYMEAD COMMUNITY BOARD RECOMMENDATION

That the staff recommendation be adopted.

SPREYDON/HEATHCOTE COMMUNITY BOARD RECOMMENDATION

That the staff recommendation be adopted.

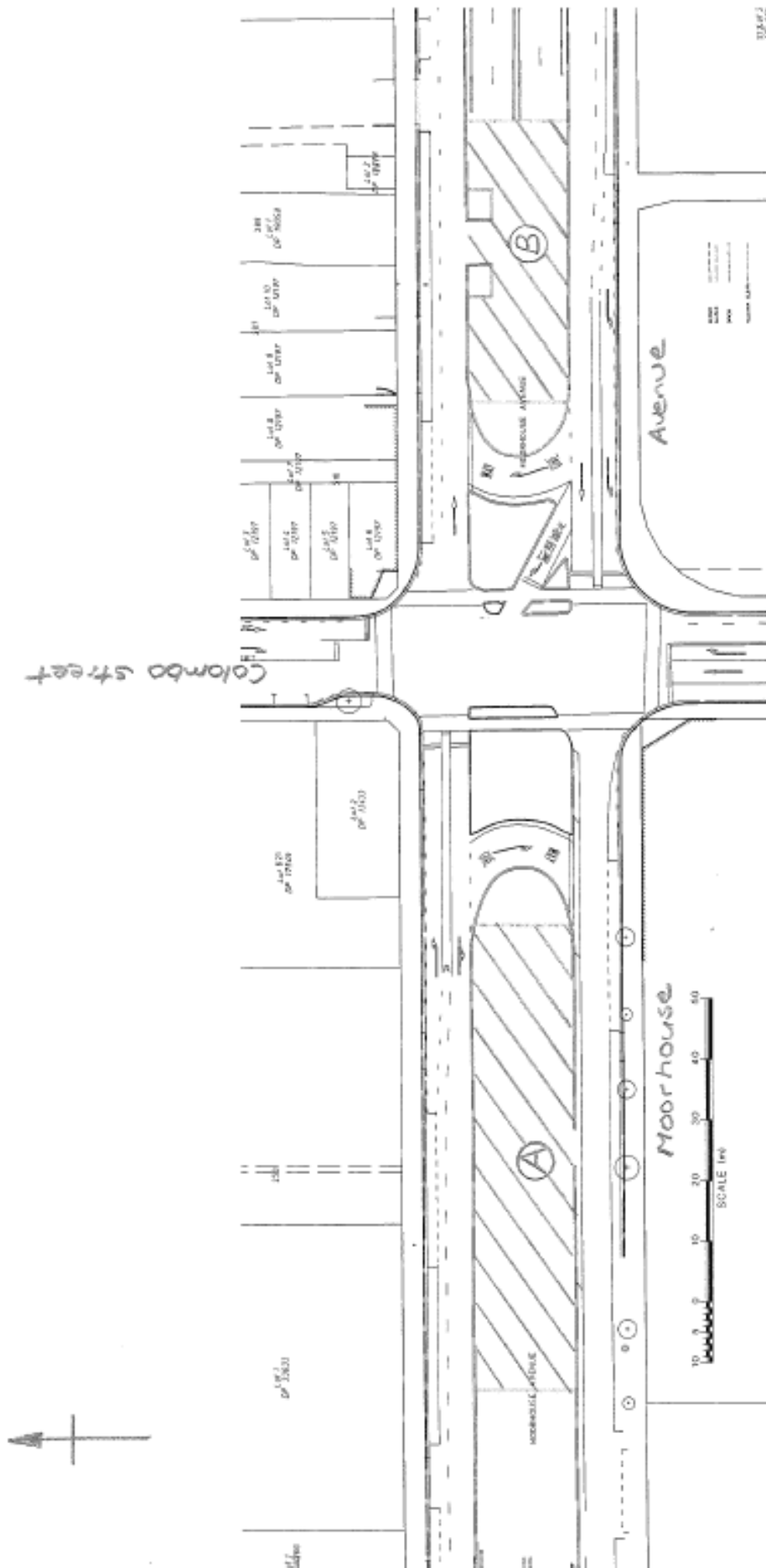

Attachment 1

Level 6, Link Centre, 152 Hereford Street
 PO Box 22 458, Christchurch 8142, New Zealand
 T: 03 366 7605 F: 03 366 7603 E: info@viastrada.co.nz



4 February 2008

Dear Business Operator/Owner

MOORHOUSE AVENUE – PROPOSED NO STOPPING (10PM TO 6AM)

ViaStrada has been contracted by the Christchurch City Council to seek your views on a proposal to install a No Stopping restriction (10pm to 6am) on Moorhouse Avenue between Colombo Street and Hagley Avenue. The restriction will also apply to the two presently unrestricted parking areas under the Moorhouse Avenue Overbridge.

It is proposed to install the No Stopping restriction on both sides of Moorhouse Avenue to help curb anti social behaviour and vandalism along the avenue. The restriction will give the Police the powers to enforce the stopping of vehicles so these activities can not take place.

The proposal is shown on the plan overleaf.

Your views are important to the Council on this matter. The Community Board will make a decision based on the feedback that is received over this proposal.

Please reply by phone, email or text no later than 15 February 2008 to:

Jeff Owen
VIASTRADA
 T: 343 8227
 M: 027 491 2026
 E: jeff@viastrada.co.nz
www.viastrada.co.nz

Yours sincerely

Jeff Owen
 Traffic Engineer

File: Publicity letter

www.viastrada.co.nz





Moorhouse Avenue – Proposed No Stopping (10pm to 6am)